



# PARDON THE MESS

We are upgrading electric wires and metal poles in your neighborhood.

## 69kv La Porte County Electric Upgrade Michigan City, IN

This short-term project will lead to long-term benefits for you:

- Enhanced safety features
- Reliability of service for years to come
- Less future maintenance work in your neighborhood

### WHAT WE'RE DOING:

Upgrading approximately 2.75 miles of electric distribution lines and 28 metal poles.

### WHEN WE WILL BE WORKING:

Work is expected to begin August 2018 and end December 2018.

Work will occur Monday through Friday from 7 a.m. - 5 p.m. On occasion, we may need to work evenings and weekends to honor customer appointments and deadlines. Schedules are weather dependent.

### OUR TEAM IN YOUR NEIGHBORHOOD:

All of our employees can be identified by marked vehicles and also carry photo ID.

### What to expect\*:

- 1. Prep work.** To make sure no other underground utilities are damaged by this work, we will call 811 to have the public utilities marked with flags, stakes and temporary paint. *Please DO NOT remove these markings.*
- 2. Assess project path.** Obstructions in utility easements, such as fences and landscapes, may need to be removed.
- 3. Access to your property.** If we need access to your yard and/or if there are any issues within the path of construction, we will reach out to you directly.
- 4. Minimal service interruptions are expected to occur.** We will notify you ahead of time if a planned outage is needed.
- 5. Clean up.** After the project is complete, we will put back fences, lay black dirt and reseed. Please remember to water the new seed so it grows.

\*If the project is complete during the winter months clean up may not happen until next spring.

# ELECTRIC UPGRADES IN YOUR NEIGHBORHOOD

## WHERE WE WILL BE WORKING:

 Area of Electric Upgrades  
(not to scale and subject to change)

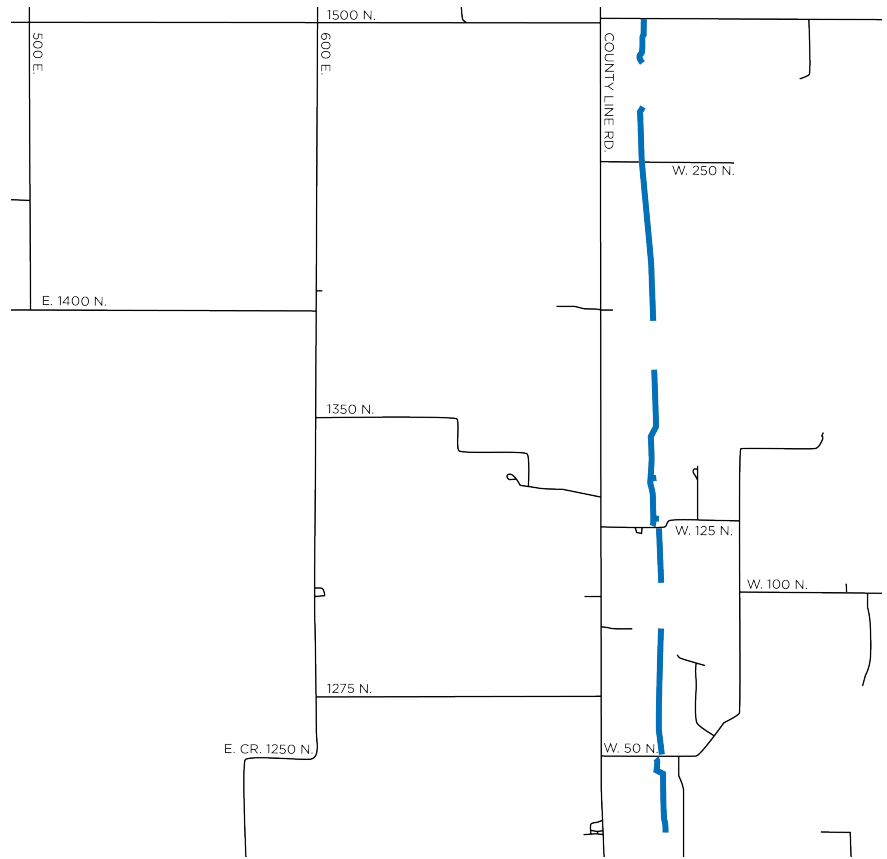

## WORK ZONE SAFETY TIPS:

- Temporary road and lane closures are expected. Signs will be posted ahead of time and detours will be in place.
- Drive with caution around our work zones. Follow the direction of traffic signs and on-site crew. We will do our best to keep traffic flowing whenever possible.
- Keep your family safe by staying away from construction areas.

## MORE INFORMATION:

- Look for door hangers that may be placed on your front door with additional updates.
- Talk with members of our team on site during the project.
- Contact us at 1-800-4-NIPSCO (1-800-464-7726). *Please reference 69kv La Porte County Electric Upgrade when calling.*

Note: If you have received this information and you are not the current property owner, please forward this information to the landlord or property owner immediately.